



K 5 GG15 Á ÛT ÖÄÛ ÄÛT ÖE

Features:
* Low VSWR

Applications:
* Wireless
* Transmitter
* Laboratory Test
* Radar

Electrical

Frequency: DC~26.5GHz
DC~18GHz (Right angle,
reversed polarity)
VSWR: 1.2 max.
Impedance: 50Ω

Mechanical

RF Connectors: SMA
Mating Life Cycle: 500 cycles
Outer Conductor: Passivated stainless steel
Dielectric: PTFE
Inner Conductor: Gold plated beryllium copper
or gold plated brass

Environmental

Temperature: -55~+85°C

Outline Drawings

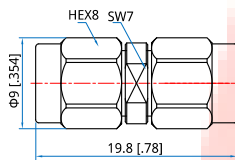

Outline A

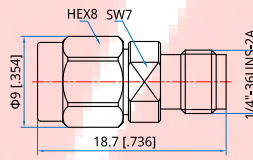

Outline B

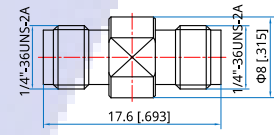

Outline C

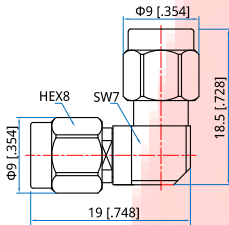

Outline D

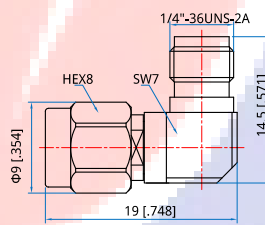

Outline E

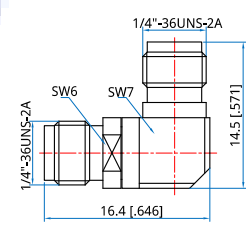

Outline F

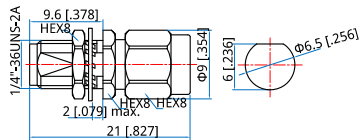

Outline G

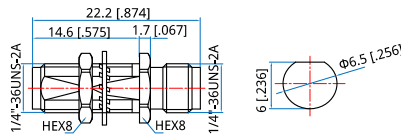

Outline H

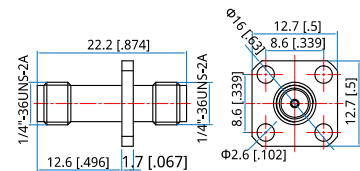

Outline I

Unit: mm [in]

Tolerance: ±0.2mm [±0.008in]

